

# Installation Guide

## SpacePole Mini Kiosk set for printer

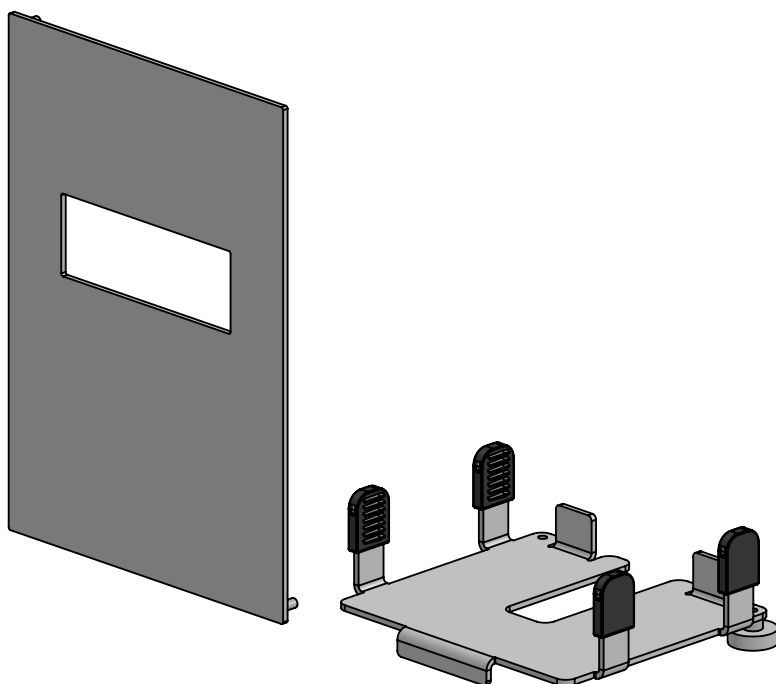



## CAUTION

- Please ensure that you read and understand the content of the installation guide before you begin the installation process.
- This product must be installed by a professional installer.
- This product is intended for indoor use only.
- This solution is designed for certified hardware and accessories. Always follow the installation guide from the hardware manufacturer for correct installation.
- Please don't power the hardware, until the entire solution is fully assembled.
- If these installation instructions are not followed precisely, it could lead to product failure and potential personal injury.
- Ergonomic Solutions / SpacePole inc. cannot be held responsible for any product failure or personal injury, if the installation instructions are not followed correctly.
- Ergonomic Solutions / SpacePole inc. cannot be held responsible for any product failure or personal injury, if any modifications have been made to the product by the customer.

## Tool list

## Box content

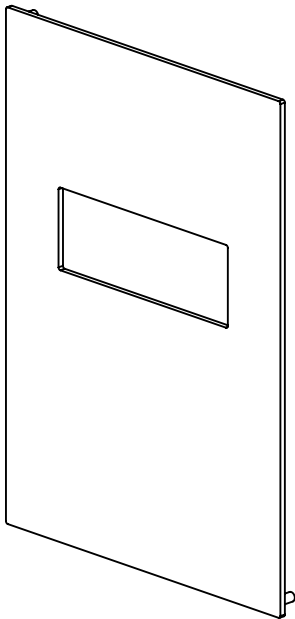

1x (A)

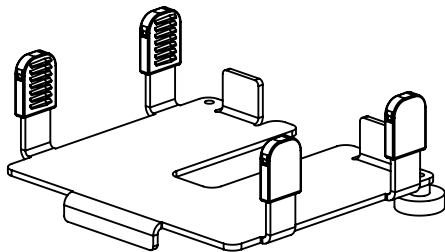

1x (B)

*Images are for illustration purposes only. Actual product may vary.*

# Steps

**Step 1:** Remove the existing magnetic printer cover and printer plate.

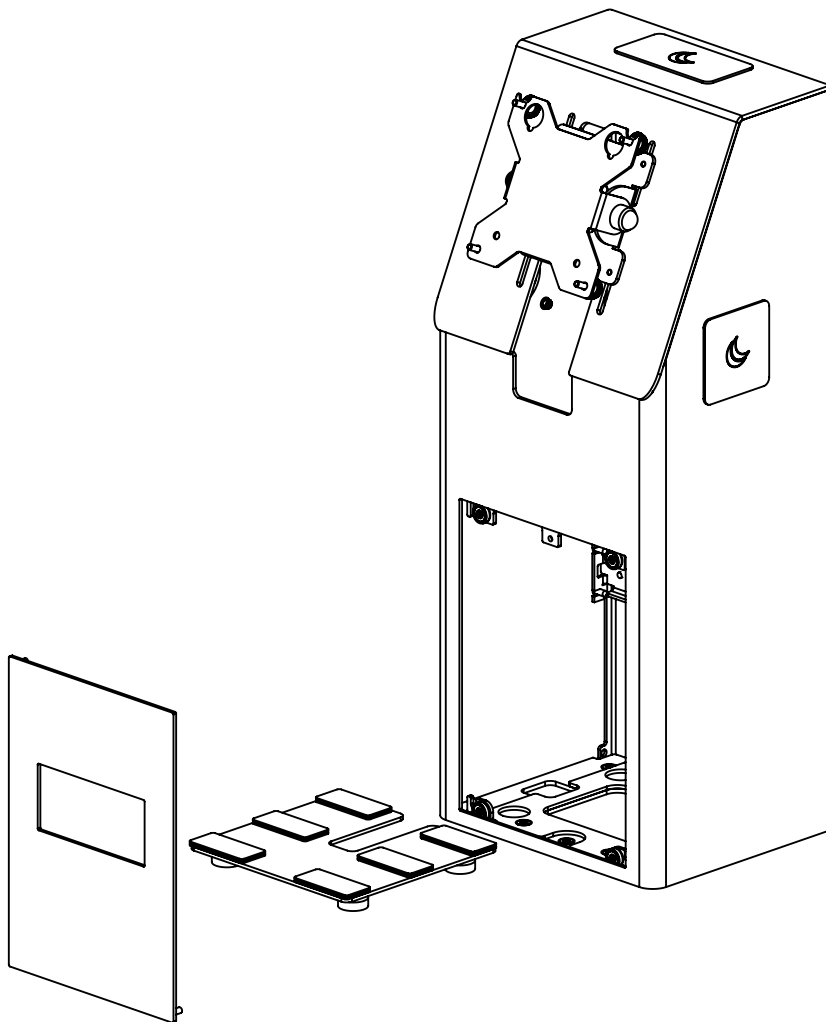

# Steps

**Step 2:** Mount the printer on the new printer plate, place the printer plate in the module, and then attach the new printer cover.

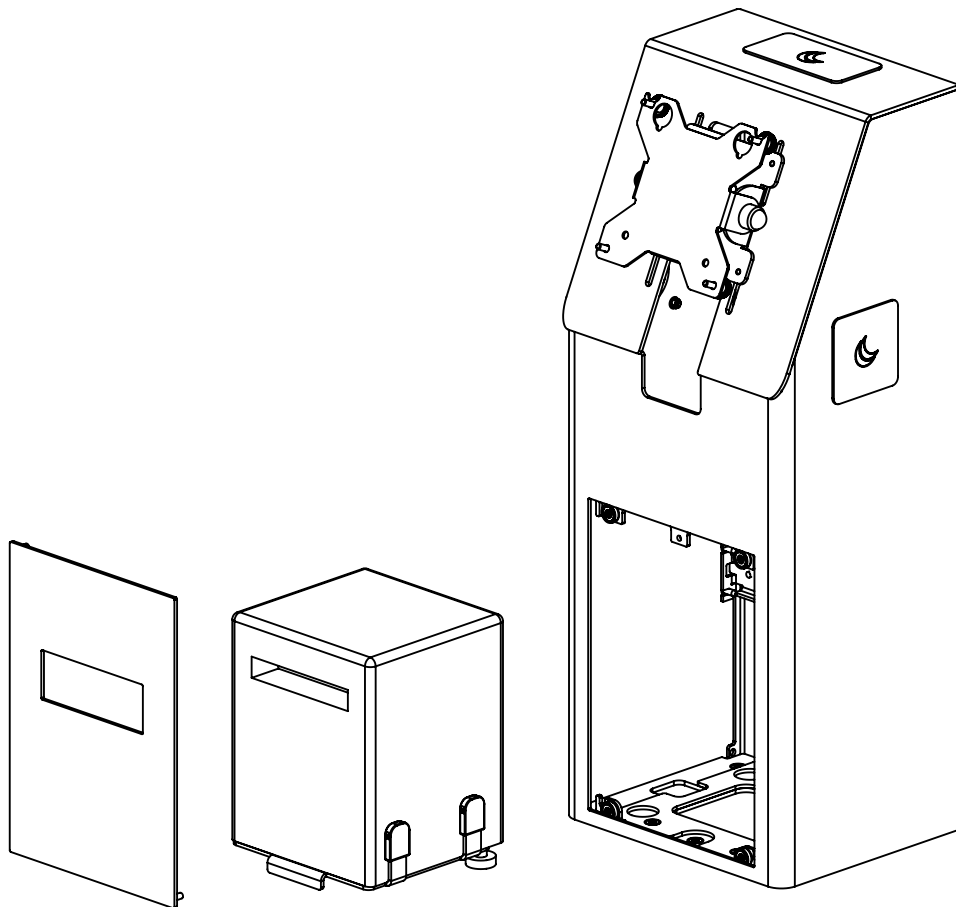

**Need help? Contact us**



**ergonomic<sup>®</sup>  
solutions**  
creators of SpacePole



**spacepole<sup>®</sup>**  
an ergonomic  
solutions company

[ergonomic.solutions/about/contact-us](https://ergonomic.solutions/about/contact-us)

[spacepole.com/about/contact-us](https://spacepole.com/about/contact-us)